

Upright Display Fridge 960L - 2 Doors - Flat Glass - Cassette

| Vertical Display & Storage



5 adjustable shelves plus base to accommodate drinks and food items of various sizes

Suitable for storage of perishable drinks and food with 3M1 climate class

Improved energy efficiency with natural refrigerant

Low-E double-glazed glass self-closing doors minimise heat transfer and prevent condensation

Powerful fan for even circulation of cold air

Lockable castors to move and position the unit with ease

Customisable lightbox for maximum brand exposure

2 Years Bronic Extra Care Warranty - Labour and Parts

High-impact LED internal lighting on each side for perfect product presentation

Fully compliant with Australian safety standards and regulations

Cassette System allows for simple on-site maintenance minimising downtime

Digital controller for easy and accurate temperature control

Upright Display Fridge 960L - 2 Doors - Flat Glass - Cassette

| Vertical Display & Storage

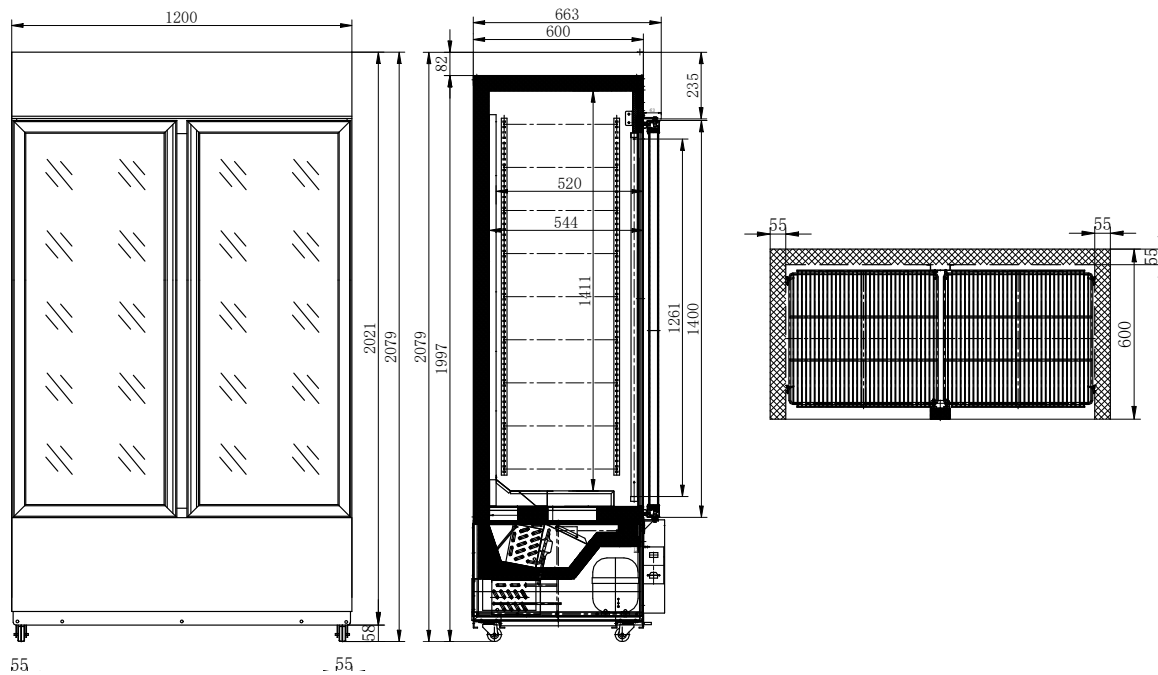

SPECIFICATIONS

Model Number	GM1000LWCAS
Part Number	3736250
Volume	960L
Unit Weight	188kg
Packaged Weight	193kg
Adjustable Temp. Range	+2°C to +5°C
Max. Ambient Temp.	38°C
Climate Class	3M1
Energy Consumption	6.86kWh/24h
GEMS Star Rating	6 stars
Refrigeration Capacity	520W
Air Circulation	Fan forced
Refrigerant	R290
Rated Current	2.3A
Electrical Voltage	220-240V
Frequency	50Hz
Power Supply	Single Phase
Power Plug	1 x 10A
Plug Location	Rear, bottom Left

Colour	White
Display Light Box	Yes
Internal Light	LED
No. of Doors	2
Door Type	Glass
Door Glass Type	Double glazed
Door Style	Hinged
Door Shape	Flat
Door Swing Dimension	600mm
Total Depth of door open	1220mm
Self-Closing Door	Yes
Door Lock	Yes
No. of Shelves incl Base	6
Shelf Type	Adjustable
Shelves Dimensions	527(w) x 478(d) mm
Temp. Controller	Digital
Castors	Yes
Warranty	2 Years Bromic Extra Care Warranty - Labour and Parts

DIMENSIONS

	External (mm)
Width	1200
Depth	690
Height	2080
	Internal (mm)
Width	1090
Depth	545
Height	1465
	Packaged (mm)
Width	1270
Depth	755
Height	2112